 Bertch[®]
USA

BUILT  LAST





Forests in the United States are among the most **PRODUCTIVE, BEST-MANAGED,** and most **SUSTAINABLE** in the world.

SUSTAINABILITY

At Bertch, we believe that good product design means, “built to last”. There are few products that are as timeless and durable as those made with hardwood lumber. Forests in the United States are among the most productive, best-managed, and most sustainable in the world. U.S. forests continue to expand in both mass and timber volume. We have always promoted wood products because of their ecological footprint. All Bertch products are considered sustainable in terms of their long lasting design and choice of materials with a limited Lifetime warranty.

As the sustainability movement continues to unfold, we’ll keep quietly doing what we’ve always done and continue to explore new ways to lessen the environmental impact of our business.

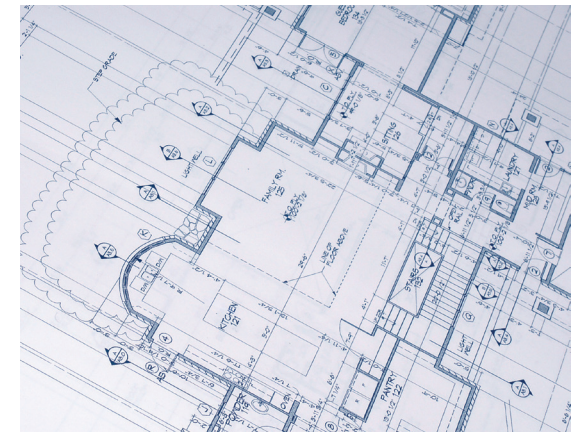

RESPONSIBILITY

Nestled in the heart of the Midwest, Bertch has been reviving the cherished art of cabinetmaking for over 40 years. Family owned and operated, all products reflect a commitment to reforestation, recycling, and a general respect for the environment. Utilizing only the finest wood, furniture joints and exceptional finishes, Bertch has the capability to create distinct products for the whole home.

As a fully integrated U.S. manufacturer, Bertch produces its own components. Eco-friendly finishing technology minimizes emissions into the atmosphere. Sawdust has been regenerated for over 25 years to produce both heat and electricity throughout campus. Community efforts include planting thousands of trees yearly to ensure the earth remains healthy.



ENVIRONMENTAL RESPONSIBILITY
has been engrained in Bertch's corporate
philosophy since our inception in 1977.



USA

Bertch delivers on company trucks, driven by company drivers. Our limited outsourcing combined with back-hauling our own materials greatly reduces sulfur oxide emissions.

We are proud to be a part of a country where most corporations understand they have a responsibility to preserve the earth's resources. Thanks to a combination of cleaner diesel fuel and new engine technology, this year the U.S. Environmental Protection Agency estimates sulfur oxide emissions (a contributor to acid rain) from heavy-duty trucks will decrease more than 100,000 tons and carbon monoxide emissions will decrease more than 70,000 tons.*

*Source: Truckinginfo.com

Can we make LIFE better?
What will the next
GENERATIONS say?





“One mature tree **ABSORBS** carbon dioxide at a rate of **48 POUNDS** per year.”

**Source: americanforests.org*

bertch.com

CULTURE

Our culture is hands on. Bertch has planted thousands of trees since 1977 and will continue to plant more.

“Trees are the most powerful concentrators of carbon on Earth. Forestry is the most sustainable of all primary industries that provide us with energy and materials. Rather than cutting fewer trees and using less wood we should promote the growth of more trees and use more wood”.
Patrick Moore, Environmental Activist

The majority of our wood waste is utilized to generate electricity and heat for our manufacturing facilities. The remainder is recycled as landscaping mulch or animal bedding.



STEWARDSHIP

Bertch is certified by KCMA's Environmental Stewardship Program (approved by NAHB), which is designed to protect our environment and encourage our industry to manage its resources.

Dick Titus, Vice President of KCMA, states "The Environmental Stewardship Program is a step above other industry environmental programs because our guidelines reach beyond raw material and management to set standards for manufacturing and product processes in regards to air quality and formaldehyde use."

Bertch is re-certified each year based on criteria of Air Quality, Resource Management (Product), Resource Management (Process), Environmental Stewardship and Community Relations.

It is Bertch's goal to not just meet the ESP requirements, but exceed them. For example, Bertch utilizes UV finishing materials that emit no air pollution. That means no Volatile Organic Compounds (VOC) are released into your home from these products. Also, Bertch employs a Solvent Recycling Program, which allows solvents to be used over and over again as a cleaner without having to dispose of the materials.





Make your **choice** matter.

bertch.com

BALANCE

The real beauty of living with Bertch cabinetry is the feeling of contributing to the environmental balance.

Along with our suppliers we continue to strive for ways to continue to make the most efficient use of our resources. Formaldehyde-free adhesives and optimizer technology are elements of our environmental program. Paper, cardboard, magazines, plastic wrap, corner blocks, light bulbs, toner cartridges, metal, and aluminum are recycled amounting to over 5 tons per year.





COMMUNITY

COMMUNITY/CHARITABLE EFFORTS INCLUDE:

- American Cancer Society
- Annual Green Scene
- Better Homes and Gardens "Green Tour" Supplier
- Black Hawk County Youth Shelter
- Camp Courageous of Iowa
- Cedar River Festival Group
- Cedar Valley Arboretum Sponsor
- Cedar Valley Hospice
- Cedar Valley United Way
- DNR's College Students in Environmental Science
- Earth Day Presentations at local schools
- Friends of Hartman Reserve
- Iowa's Waste Reduction Center
- Junior Achievement
- Major Donor to Northeast Iowa food bank
- Member of State's Earth Year Steering Committee
- Multiple winner of Governor's Award for Waste Reduction Projects
- Muscular Dystrophy Association
- Provides tuition for associates seeking continued education
- Special Olympics Iowa
- Sunrise Exchange Club
- Toys for Tots
- Wellness Center for all Bertch Employees and their families
- Blue Zones Worksite



bertch.com